

CRAFTED LIKE NO OTHER

DON'T JUST SETTLE
FOR THE SAME
OLD BULL

OWNER MANUAL

MAZDA
BT-50 2021+

AFN
4X4 ACCESSORIES



WELCOME TO THE AFN FAMILY

This manual contains the Mazda BT-50 +2021 fitting instructions for:
Bull Bar w/ Fog Lights Ref.: 48002831

1 INTRODUCTION

The Company

Founded in 1995, AFN - 4x4 Accessories dedicates itself to the production and commerce of all-terrain accessories. Its constant concern in its customers total satisfaction, and in the ideals of innovation and transformation have granted a position of notability both in the national and international panorama.

The only company in Portugal in the mass production of 4x4 accessories, relies on specialized and experienced technicians, with the most adequate knowledge, to an efficient response capability to its customers demands.

Thanks to the specialization in the several areas of design and manufacture and to a constant investment in technology, AFN has been broadening its wide range of products, without ever neglecting the quality factor.

4x4 Accessories

In its diversity of products we can include, with all-terrain quality, protection, safety and aesthetic accessories.

And it is here that AFN invest on the best technology, the best cut precision of the raw material, and the transformation of products with the quality recognized in the marketplace.

AFN has, at its disposal, resources to test and analyse the resistance of its products and stands in the front row regarding the European homologation of materials dedicated to all terrain.

The contact with the most important test laboratories for vehicles, both in England, Spain and Germany, provides AFN with the know-how to manufacture a wide range of quality products.

Our Design Approach

AFN designs each accessory taking into consideration the original model lines and fitting points. We refuse to have a "one design fits all" solution and we are always looking forward to embrace new challenges on how to adjust a new product into a new model!

The days of just throwing on a bit of steel together to form a protection system are gone. AFN is leading the way modern vehicle protection components are manufactured. Other will follow, and it won't be long where the AFN approach to Styling, Fit, Form and Function will become the benchmark for all other manufacturers.





INDEX

AFN 4x4 Accessories

Product: **Bull Bar w/ Provision for OEM Fog light and AFN indicator**
Part Ref.: **48002831**

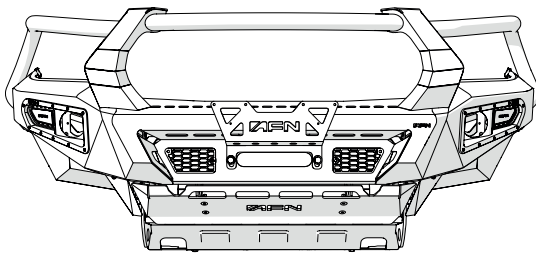

Introduction 2

1 Checklist 4
Product 48002831

2 Fitting Instructions 6

3 BT-50 Catalogue 23

4 Warranty Terms 24

5 Attachments 25



1 CHECKLIST

- In this section you have a checklist with all parts included for the installation of your AFN product
- This product should be installed as demonstrated in the product fitting instructions
- If verified that any component is damaged, please contact your nearest AFN distributor
- The specified parts will only fit in the models specified by AFN
- Do not modify any component of the product

This checklist is only for the product **48002831**.

| NUMBER | DESCRIPTION | REFERENCE | QTY | NUMBER | DESCRIPTION | REFERENCE | QTY |
|--------|---|-----------|-----|--------|---|-----------|-----|
| 1 | Bull Bar - Mazda BT-50 2021 | 47002580 | 1x | 35 | Washer M8 | 45001255 | 4x |
| 2 | Right Wing | 47002579 | 1x | 36 | Washer M6 | 45001256 | 4x |
| 3 | Left Wing | 47002578 | 1x | 37 | Washer M8 (big) | 45001267 | 4x |
| 4 | Lower Skid Plate | 47002398 | 1x | 38 | Rubber Nut | 45001269 | 4x |
| 5 | Bumper Grill (Right Side) | 47002393 | 1x | 39 | Nylock Nut M8 | 45001521 | 4x |
| 6 | Bumper Grill (Left Side) | 47002392 | 1x | 40 | Nylock Nut M6 | 45001522 | 4x |
| 7 | Triple Nut Plate (Right Side) | 47002313 | 1x | 41 | Bolt M8x25 | 45001537 | 4x |
| 8 | Triple Nut Plate (Left Side) | 47002312 | 1x | 42 | Bolt M12x40 | 45001544 | 4x |
| 9 | Recovery Point (Right Side) | 47002311 | 1x | 43 | Bolt M10x35 | 45001553 | 6x |
| 10 | Recovery Point (Left Side) | 47002310 | 1x | 44 | Nylock Nut M10 | 45001554 | 2x |
| 11 | Winch Bracket | 47002309 | 1x | 45 | Bolt M12x30 | 45001565 | 8x |
| 12 | AFN LED Indicator Lights - (Right Side) | 47002089 | 1x | 46 | Bolt M10x35x1.25 | 45001621 | 6x |
| 13 | AFN LED Indicator Lights - (Left Side) | 47002088 | 1x | 47 | Lock Nut M10 | 45001707 | 4x |
| 14 | Mask for Fog and Indicator Lights - (Left Side) | 48002544 | 1x | 48 | Lock Nut M12 | 45001710 | 8x |
| 15 | Mask for Fog and Indicator Lights - (Left Side) | 48002545 | 1x | 49 | Plastic Washer M6 | 45001802 | 12x |
| 16 | Bolt M12x90x35 | 45000266 | 2x | 50 | Bolt M5x15 | 45001889 | 2x |
| 17 | Bolt M6x20 | 45000387 | 4x | 51 | Nylock Nut M5 | 45001891 | 2x |
| 18 | Washer M5 (big) | 45000476 | 2x | 52 | Front Winch Bracket Shim 2,5mm thickness | 46008193 | 1x |
| 19 | Rubber 512mm | 45000502 | 2x | 53 | Front Winch Bracket Shim 4mm thickness | 46008194 | 1x |
| 20 | Bolt M10x30 | 45000934 | 4x | 54 | Plate Bracket | 46008444 | 1x |
| 21 | Washer M6 | 45000979 | 12x | 55 | Front Skid Plate STAINLESS STEEL | 46009289 | 1x |
| 22 | Washer M12 STAINLESS STEEL | 45000995 | 4x | 56 | Winch Reinforcement (Clamp) | 46009295 | 2x |
| 23 | Bolt M6x20 STAINLESS STEEL | 45000998 | 16x | 57 | Side Winch Bracket Shim 4mm thickness | 46009296 | 2x |
| 24 | Cage Nut M6 | 45001012 | 16x | 58 | Side Winch Bracket Shim 2,5mm thickness | 46009297 | 2x |
| 25 | Bolt M12x30 STAINLESS STEEL | 45001027 | 2x | 59 | Double Hole Washer | 46009303 | 2x |
| 26 | Nylock Nut M12 | 45001033 | 2x | 60 | Fog Light Bracket (Left Side) | 46009971 | 1x |
| 27 | Bolt M10x30 STAINLESS STEEL | 45001103 | 2x | 61 | Fog Light Bracket (Right Side) | 46009972 | 1x |
| 28 | Plastic Nut M3,5 | 45001113 | 12x | 62 | Reinforcement for Spotlights | 46010675 | 1x |
| 29 | Bolt M3,5x16 STAINLESS STEEL | 45001123 | 12x | 63 | Bracket for OEM Headlight (Left Side) | 46010815 | 1x |
| 30 | Flange Nut M4 | 45001166 | 8x | 64 | Bracket for OEM Headlight (Right Side) | 46010816 | 1x |
| 31 | Bolt M4x12 STAINLESS STEEL | 45001232 | 8x | 65 | Headlight Reinforcement | 46010999 | 2x |
| 32 | Washer M12 (big) | 45001250 | 22x | 66 | Side Plastic (Left Side) | 46011000 | 1x |
| 33 | Washer M10 (big) | 45001251 | 10x | 67 | Side Plastic (Right Side) | 46011001 | 1x |
| 34 | Washer M10 (small) | 45001254 | 10x | | | | |

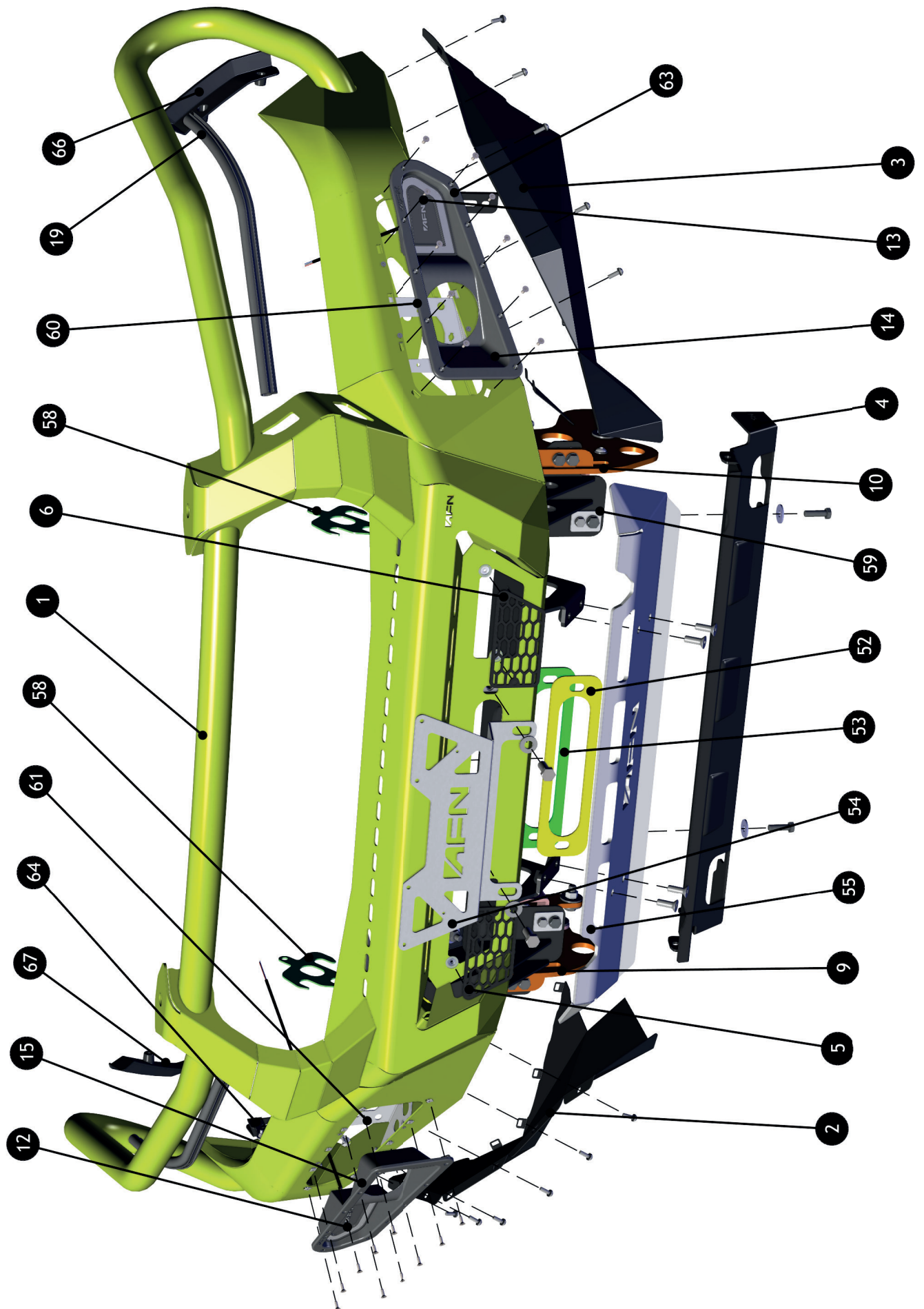

2 FITTING INSTRUCTIONS

WARNING:

Before you begin installation, read all instructions thoroughly.
Proper tools will improve the quality of installation and reduce the time required.

- This product should be installed as demonstrated in the *Product «Fitting Instructions»*;
- The specified parts, will only fit the models specified by **AFN**;
- Do not modify any component of the product;
- It is recommended that this product is installed by specialized and trained personnel;
- AFN doesn't take responsibility for changes made in the vehicle by its manufacturer;
- Work safely and use specialized tools at all times;
- **Always use protective gear.**



| Size | Torque Nm | Torque lbft |
|------|-----------|-------------|
| M6 | 9 Nm | 7 lbft |
| M8 | 22 Nm | 16 lbft |
| M10 | 44 Nm | 32 lbft |
| M12 | 77 Nm | 57 lbft |

Mouting Time

- 3 hours
- 2 persons (recommended)

Tools Required

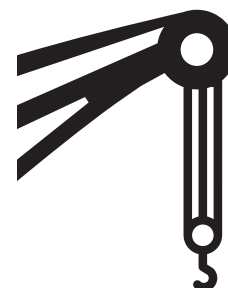
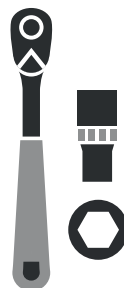

- Screwdriver star head
- Screwdriver flat head
- Wrench
- Wire cutter
- Ratchet wrench
- Allen wrench
- Crane

ATTENTION! - READ THIS BEFORE YOU START FITTING THE AFN BULLBAR | BUMPER

AFN has developed an easy and quick mounting system, where the assembly part combines both the AFN Bullbar | Front Bumper(1) and Winch Bracket(2) that is fitted on the vehicle, at once.

This assembly goes from factory, fully tightened with shims. This is what we call the «0 point of the AFN Bullbar | Front Bumper(1)».

The holes on the **Red Circles** must be correctly aligned in order to the AFN Bullbar | Bumper Assembly is on «0 point».

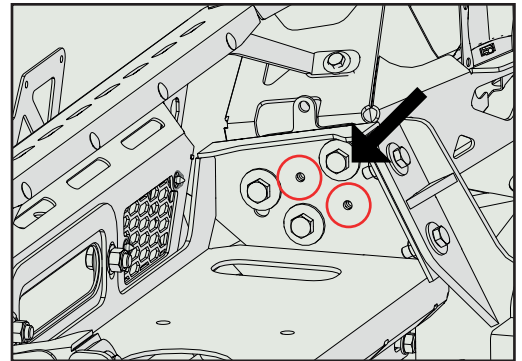
**ADJUSTING THE AFN BULLBAR | BUMPER**

Every AFN Bull Bar | Front Bumper is designed taking into consideration the vehicle's original lines.

In order to give a good response in terms of design, resistance and functionality, we've created some ways to adjust the AFN Bull Bar | Front Bumper to the vehicle, depending on the customer's preferences.

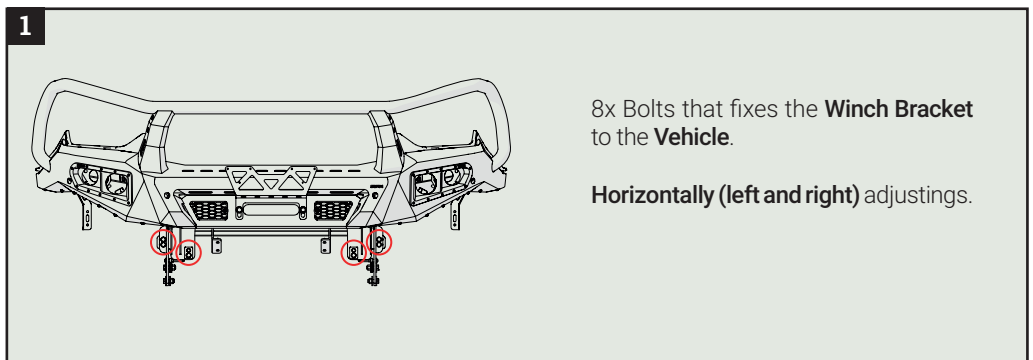

1 - When loosen -> allows the AFN Bull Bar | Front Bumper to be adjusted **horizontally**.

2 - When loosen -> allows the AFN Bull Bar | Front Bumper to be adjusted **vertically and depth**.

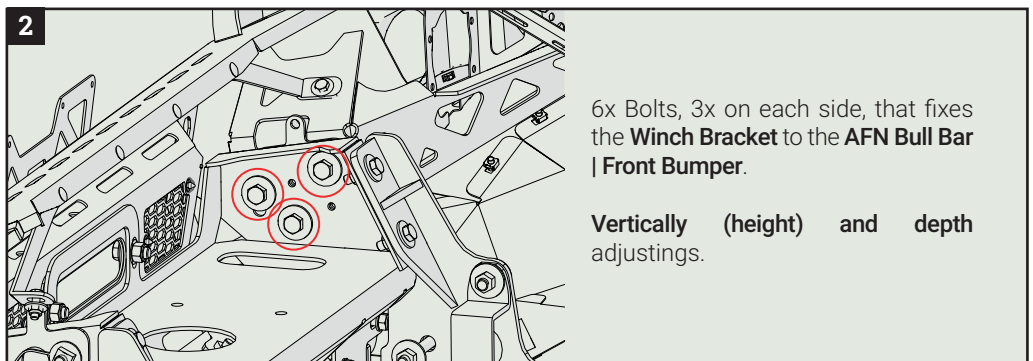
**Step 1**

Start by cutting the **OEM* Grill**.

Bear in mind that this a precision task, so please take time to correctly trim the Grill.

You may apply some tape to mark the trimming line and then cut it.

See the image on the right that shows how it should be done.

You may have to do the final touches in the trimming the grill. When it's done, and if you want to do a cleaner job, you may use a file to smooth the rough edges.



*OEM - Original Equipment Manufacturer

Step 2 - Preparation of the AFN Bullbar | Front Bumper

Preview

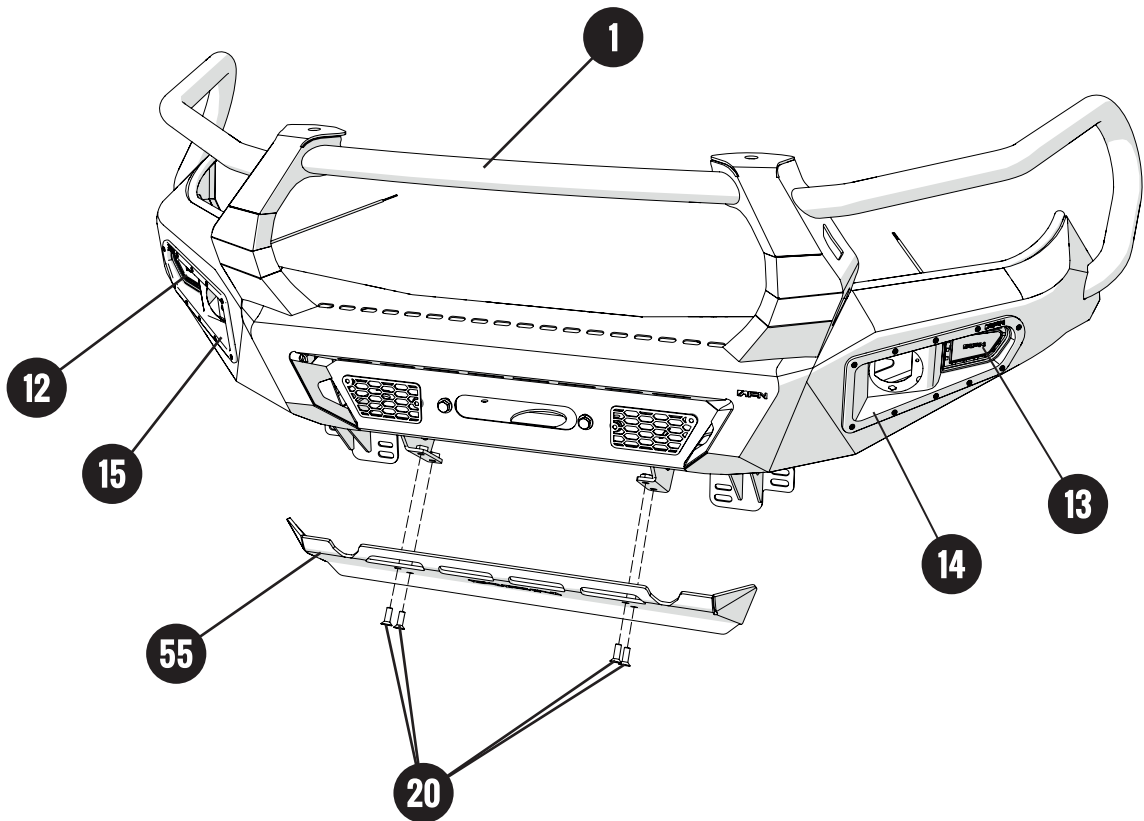

Parts needed:

1

12

13

14

15

20

x1 Bull Bar MAZDA BT-50 2021

x1 Mask for Fog and Indic. Lights Left Side

x1 Mask for Fog and Indic. Lights Right Side

x1 Mask for Fog and Indic. Lights Left Side

x1 Mask for Fog and Indic. Lights Right Side

x4 Bolt M10x30

30

31

55

60

61

x8 Flange Nut M4

x8 Bolt M4x12

x1 Front Skid Plate

x1 Alum. Bracket for OEM Lights Left Side

x1 Alum. Bracket for OEM Lights Right Side

12 48002544

| NUMBER | REF | QUANTITY |
|--------|----------|----------|
| A1 | 4607977 | 1x |
| B1 | 45001114 | 10x |
| C1 | 45001113 | 10x |

13 48002445

| NUMBER | REF | QUANTITY |
|--------|----------|----------|
| A2 | 46007978 | 1x |
| B2 | 45001114 | 10x |
| C2 | 45001113 | 10x |

Step 2 - Preparation of the AFN Bullbar | Front Bumper**Installation**

Before installing the **AFN Bullbar | Front Bumper(1)** on the vehicle there are some details that we advise to do first, in order to be easier the fitting into the vehicle.

Start by removing the **Front Skid Plate(55)** from the **AFN Bullbar | Front Bumper(1)**.

You may leave the 4x Bolts **M10x30(20)** finger tightened in the **Winch Bracket(2)**, so you don't lose them.

The **Front Skid Plate(55)** will be fitted again, later on. *(these bolts are already fitted on the Bumper)*

Then, remove the **Plastic Mask for Fog and Indicator Lights(A1) -> (14)**.

10x Bolts **M4x16 (B1)**. *(these bolts are already fitted on the Bumper)*

Also remove the **Aluminium Bracket(70)**.

4x Bolts **M4x12(31)** with 4x Flange Nuts **M4(30)**. *(these bolts are already fitted on the Bumper)*

Once that is done, fit the **OEM* Fog and Indicator Lights** on the **Left Aluminium Bracket(60)**.

Please note the triangles on the **Left Aluminium Bracket(60)**, which indicates the right orientation when fitting. **They must be up.** *(red circles)*

Repeat this step for the other side, using **Right Aluminium Bracket(61)**.

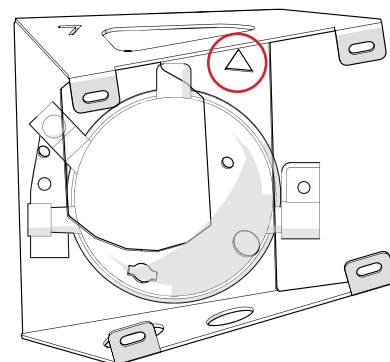
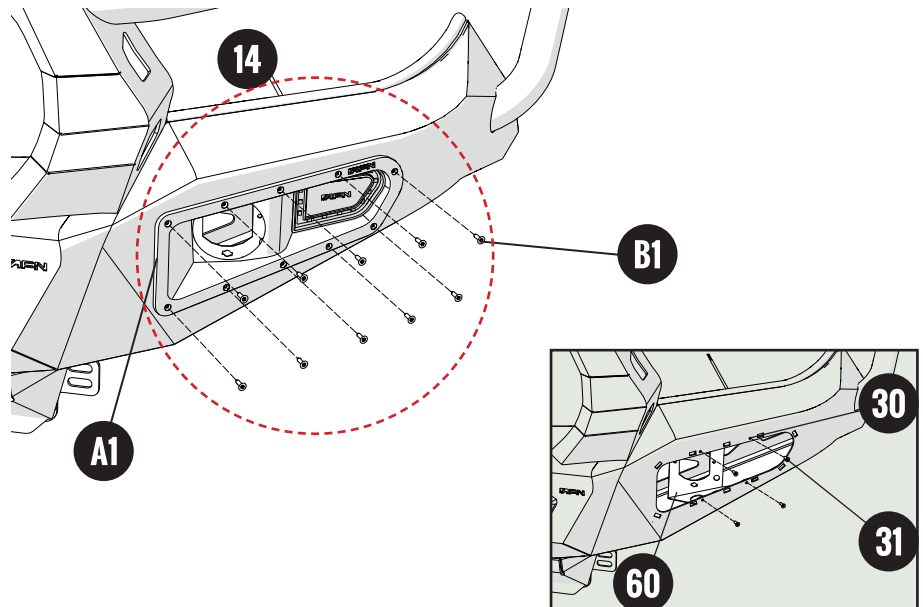
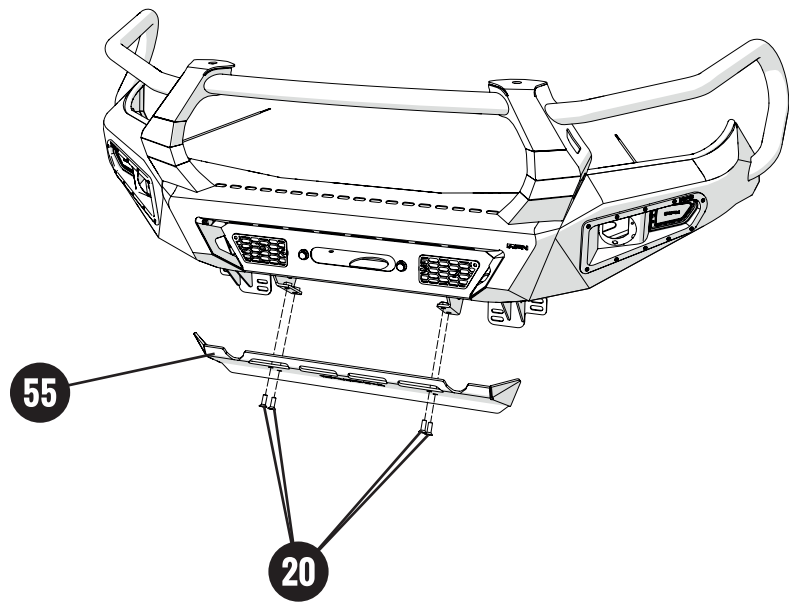
**FOG LIGHT**

Step 3 - Fitting the Headlight Brackets

Preview

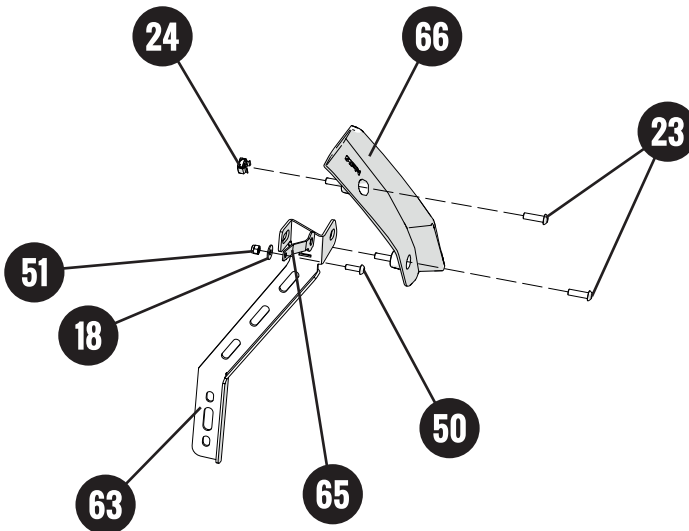
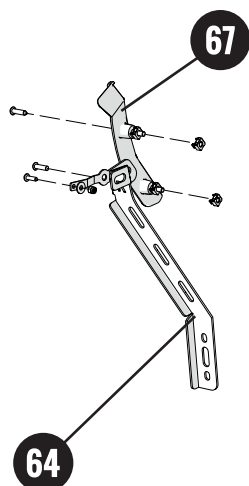

Parts needed:

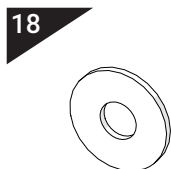

x2 Washer (big) M5

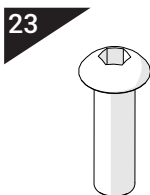

x4 Bolt M6x20

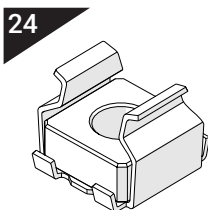

x4 Cage Nut M6

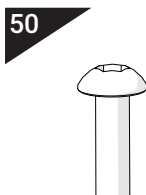

x2 Bolt M5x15

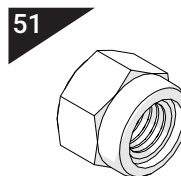

x2 Nylock Nut M5

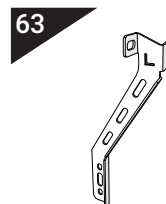

x1 Bracket f/ OEM Headlight Left Side

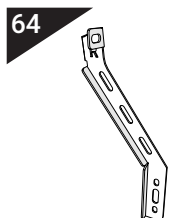

x1 Bracket f/ OEM Headlight Right Side

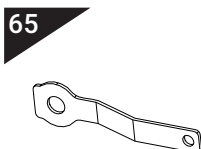

x2 Headlight Reinforcement

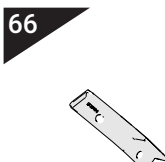

x1 Side Plastic Left Side

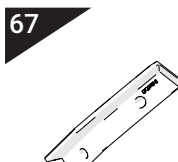

x1 Side Plastic Right Side

Step 3 - Fitting the Headlight Brackets

Installation

Before fitting the **AFN Bullbar | Front Bumper(1)** on the vehicle there are some details that we advise to do first.

Start by fitting the **Left Headlight Bracket(63)**, using 2x OEM* Bolts.

Then, fit the **Headlight Reinforcement(65)** in the vehicle, using 1x **M5x15(50)** with 1x Washer **M5(18)** and 1x Nylock Nut **M5(51)**.

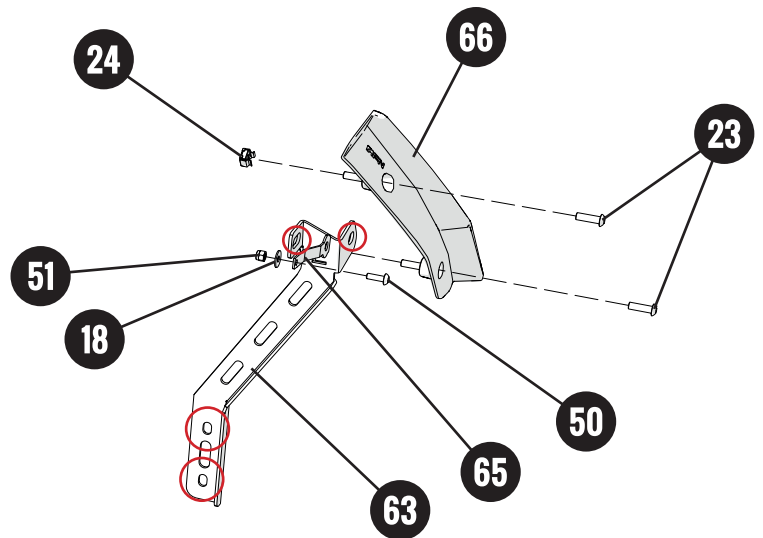

Once that is done, fit the **Left Side Plastic(66)**, using 2x Bolts **M6x20 (23)** with 2x Cage Nuts **M6(24)**. (see red circles, on picture below)

Give the final torque.

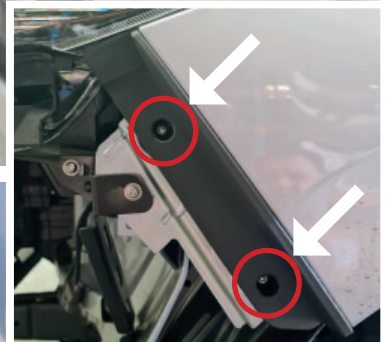
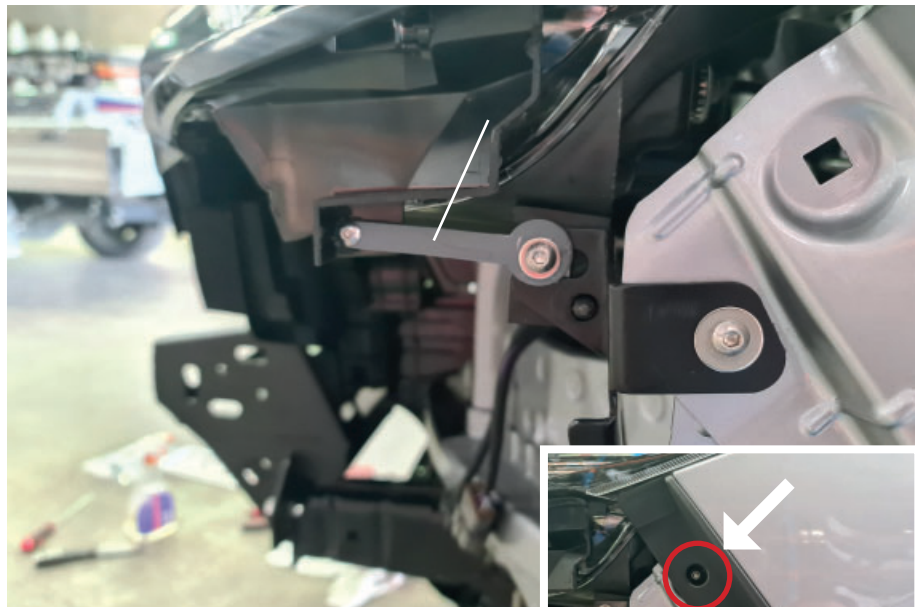

Repeat all of these steps for the other side, using **Right Headlight Bracket(64)** with 1x **Headlight Reinforcement(65)** and **Right Side Plastic(67)**.

Give the final torque.



Step 4 - Fitting the AFN Bumper and Winch Bracket Assembly on Chassis

Preview

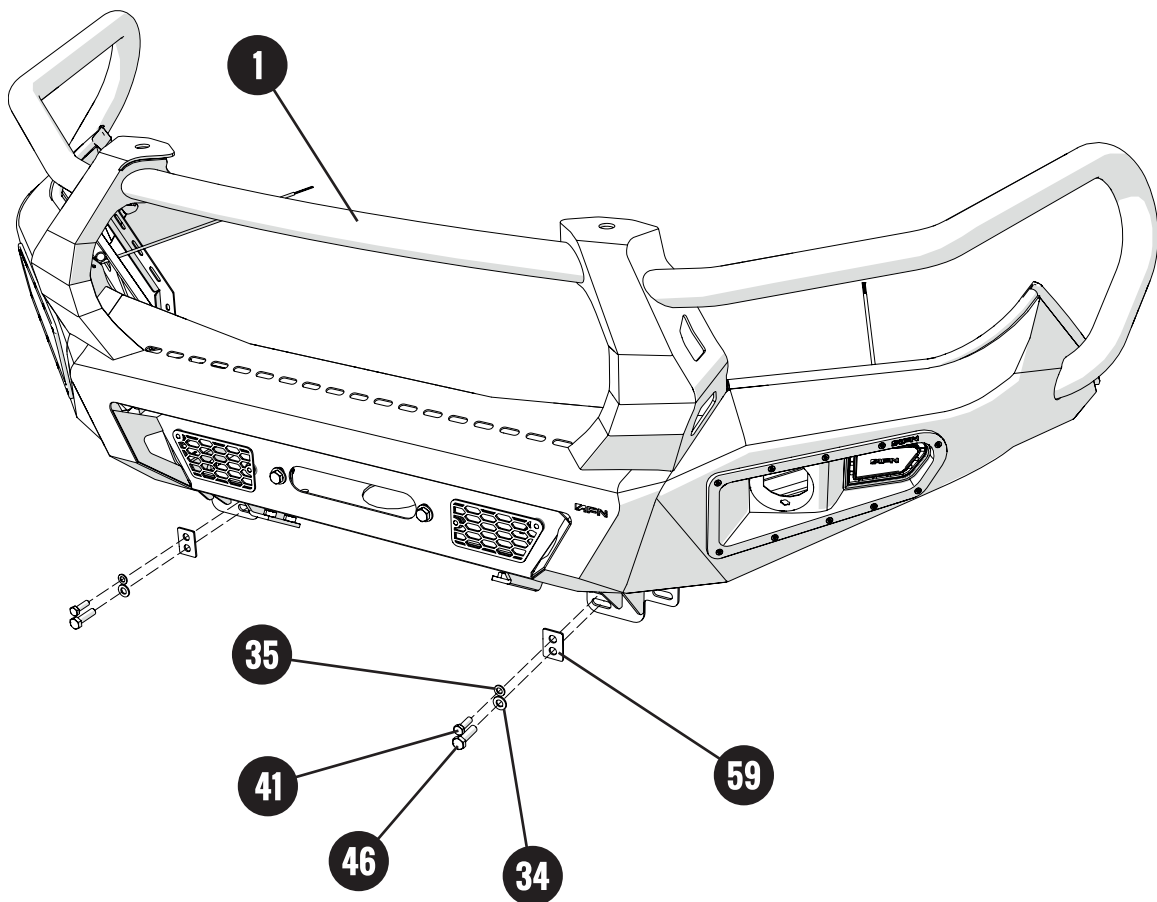

Parts needed:

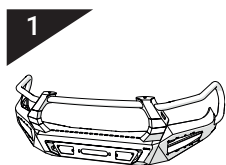

x1 Bull Bar MAZDA BT-50 2021

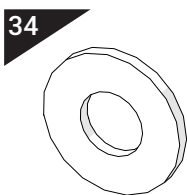

x2 Washer M10

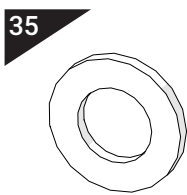

x4 Washer M8

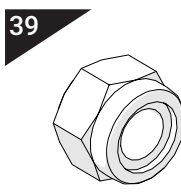

x2 Nylock Nut M8

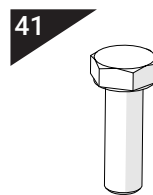

x2 Bolt M8x25

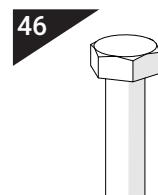

x2 Bolt M10x35x1.25

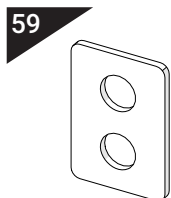

x2 Double Hole Washer

Step 4 - Fitting the AFN Bumper and Winch Bracket Assembly on Chassis**Installation****ATTENTION!**

AFN has developed an easy and quick mounting system, where the assembly part combines both the AFN Bullbar | Front Bumper(1) and Winch Bracket(2) that is fitted on the vehicle, at once. This assembly goes from factory, fully tightened with shims. This is what we call the «0 point of the AFN Bullbar | Front Bumper(1)».

The holes on the **Red Circles** must be correctly align in order to the **AFN Bullbar | Bumper Assembly** is on «0 point».

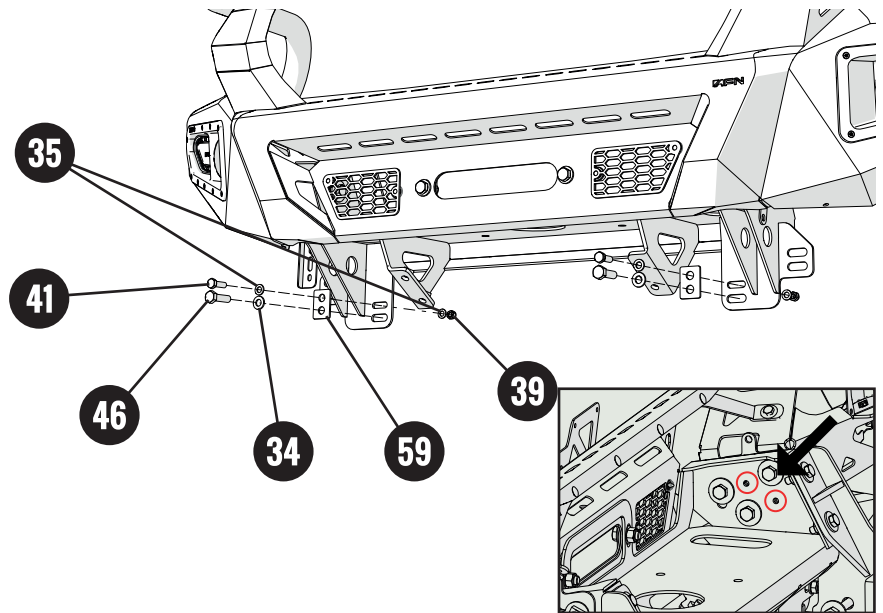

So, with help of another person or a crane, lift the **AFN Bullbar | Bumper Assembly** and fit it in the vehicle, as shown in the image.

Use 2x Bolts **M10x35x1.25(46)**, with 2x Washers **M10(34)**, and 2x Double Hole Washer(**59**), in the bottom.

Then, on top, use 2x Bolts **M8x25(41)**, with 4x Washers **M8(35)** and 1x Nylock Nut **M8(39)**.

Just finger tight all bolts

Do Not tighten yet.

If you have done it correctly, this is what it should look like.



Step 5 - Fitting the AFN Recovery Points on Winch Bracket and Chassis

Preview

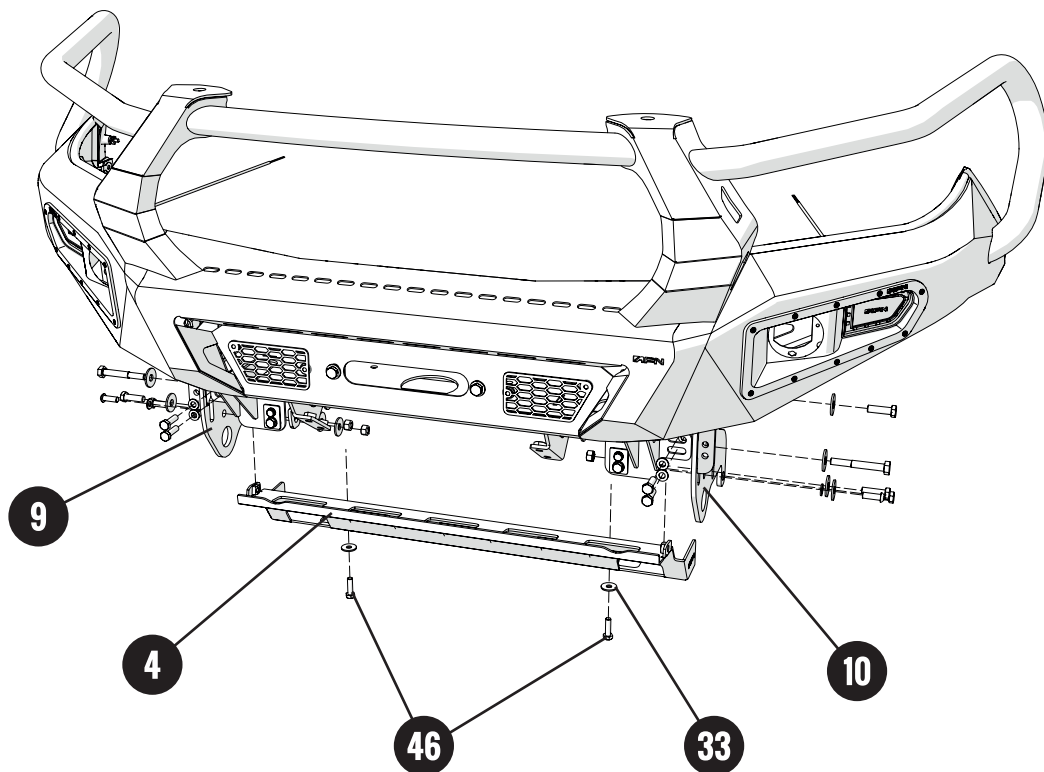

Parts needed:

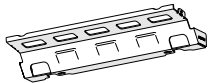
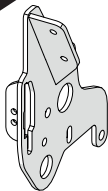
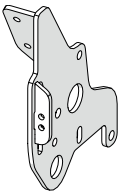
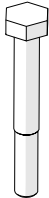
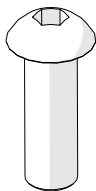
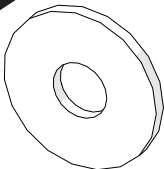
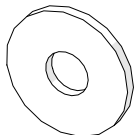
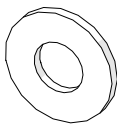
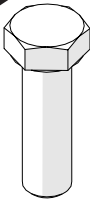
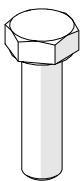
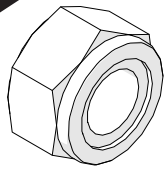
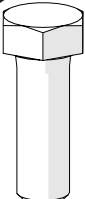
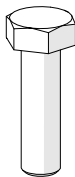
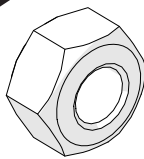
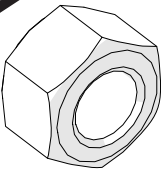
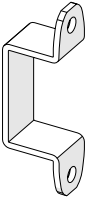
- | | | | | | |
|--|--|--|---|--|---|
| <p>4</p>  <p>x1 Lower Skid Plate</p> | <p>9</p>  <p>x1 Recovery Point Right Side</p> | <p>11</p>  <p>x1 Recovery Point Left Side</p> | <p>16</p>  <p>x2 Bolt M12x90x35</p> | <p>29</p>  <p>x2 Bolt M10x30</p> | <p>32</p>  <p>x16 Washer M12</p> |
| <p>33</p>  <p>x10 Washer M10 Big</p> | <p>34</p>  <p>x6 Washer M10 Small</p> | <p>42</p>  <p>x4 Bolt M12x40</p> | <p>43</p>  <p>x6 Bolt M10x35</p> | <p>44</p>  <p>x2 Nylock Nut M10</p> | <p>45</p>  <p>x2 Bolt M12x30</p> |
| <p>46</p>  <p>x2 Bolt M10x35x1.25</p> | <p>47</p>  <p>x4 Lock Nut M10</p> | <p>48</p>  <p>x8 Lock Nut M12</p> | <p>56</p>  <p>x2 Winch Reinforcement Clamp</p> | | |

Step 5 - Fitting the AFN Recovery Points on Winch Bracket and Chassis**Installation**

Once the **Assembly** is fitted, it's time to fit **Left Recovery Point(10)** connecting the **Winch Bracket(2)** to the **Chassis**.

Use 1x Bolt **M10x35x1.25(16)**, with 1x Washer **M10(32)**, on top.

On the bolts that fit directly into the chassis be careful so you don't damage the Chassis' thread pitch.

Use 1x Bolt **M10x35(43)**, with 2x Washers **M10(34)** and 1x Nylock Nut **M10(44)**, on bottom.

Then, on the side, use 1x Bolt **M12x30(45)** with 2x Washers **M12(32)** and 1x Lock Nut **M12(48)**.

Also, on the side, use 2x Bolts **M10x35(43)** with 4x Washers **M10(33)** and 2x Lock Nuts **M10(47)**.

Then, use 2x Bolts **M12x40(42)**, with 4x Washers **M12(32)** and 2x Lock Nuts **M12(48)** to fit the interior **CLAMP(56)**.

Repeat all of these steps for the other side, using **Right Recovery Point(9)**.

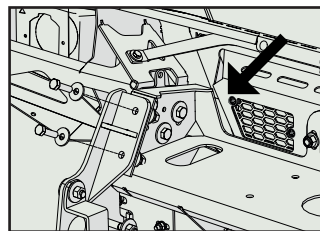
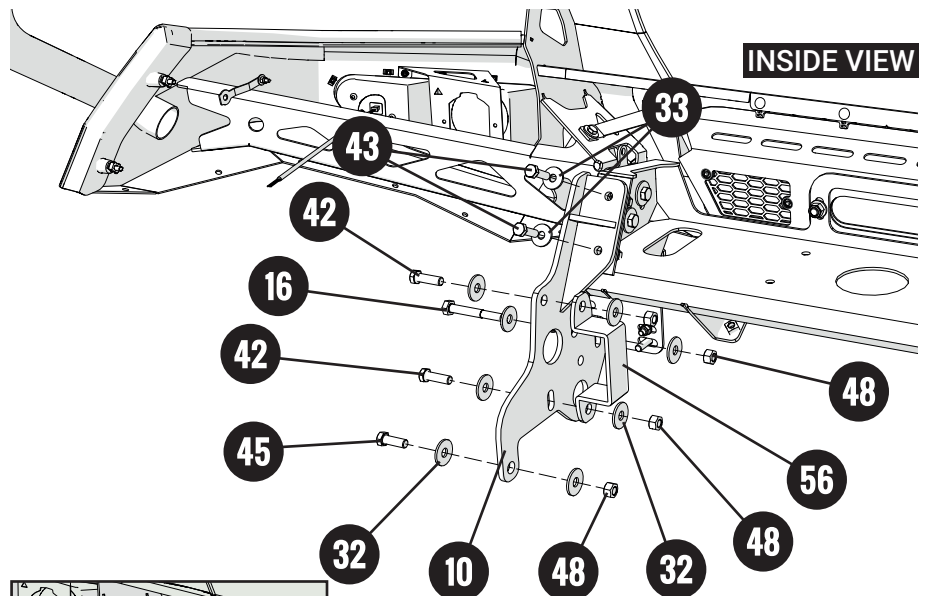
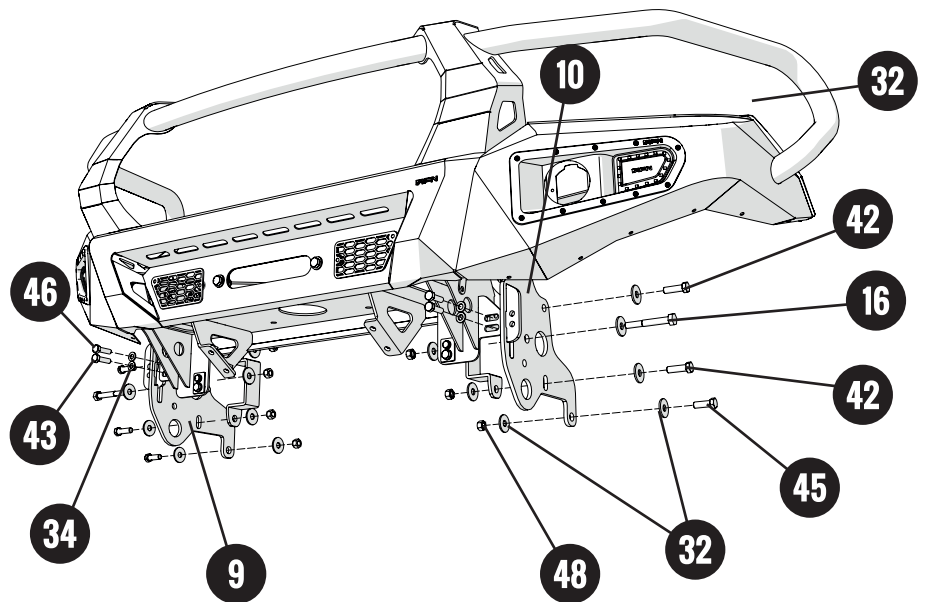

Once both **Recovery Points** are fitted, it's time for the **Lower Skid Plate(46)**.

Use 2x Bolts **M10x35x1.25(46)** and 2x Washers **M10(33)**, on bottom.

On sides use 2x Bolts **M10x30(27)** with 2x Washers **M10(34)**.

Just finger tight all bolts

Do Not tighten yet.

If you have done it correctly, this is what it should look like.

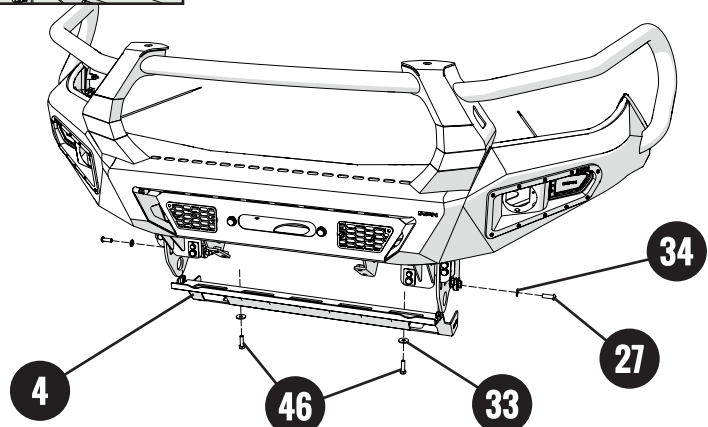

Step 6 - Full tightening the AFN Bullbar | Front Bumper

Preview

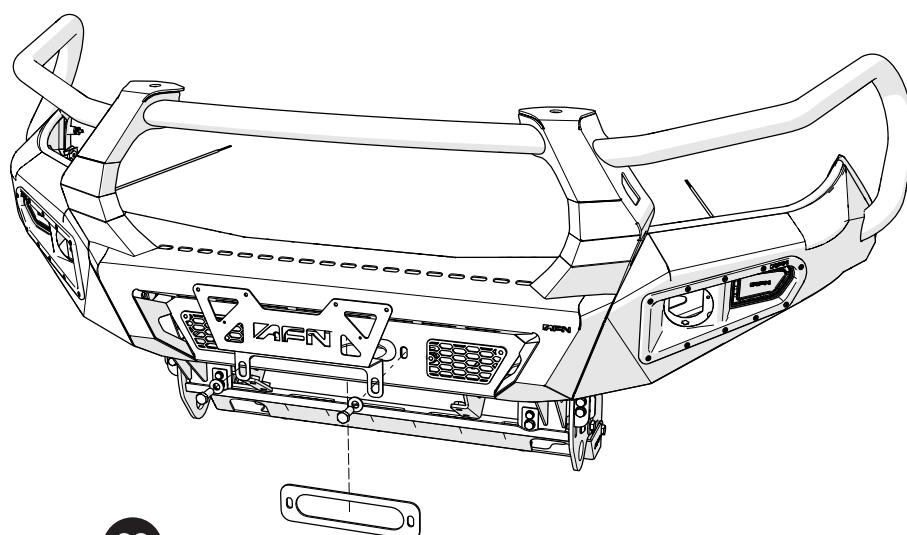

22

26

Parts needed:

22

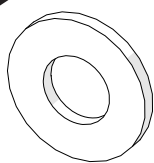

x4 Washer M12

25

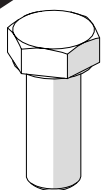

x2 Bolt M12x30

26

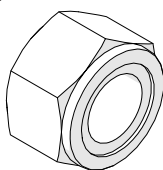

x2 Washer M12

52

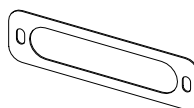

x1 Front Winch Bracket Shim
2,5mm thickness

53

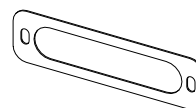

x1 Front Winch Bracket Shim
4mm thickness

54

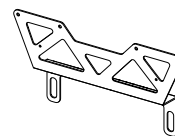

x1 Plate Bracket

57

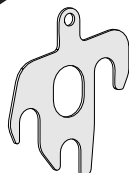

x2 Side Winch Bracket Shim
4mm thickness

58

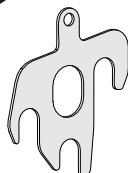

x2 Side Winch Bracket Shim
2,5mm thickness

Step 6 - Full tightening the AFN Bullbar | Front Bumper**Installation**

Start by loosen the 2x Bolts of the Center in the **AFN Bullbar | Front Bumper(1)**, one at a time.

Then, fit the **Plate Bracket(54)** using the same 2x Bolts **M12x30(25)** with 4x Washers **M12(22)** and 2x Nylock Nuts **M12(26)**. *(these bolts are already fitted on the Bumper)*

Now, it's time to check if the **AFN Bullbar | Bumper(1)** is correctly aligned to the **Vehicle**.

If not, loosen the **Bolts of the Winch Mount** and **ADD/REMOVE** the shims, depending on what suits better between the **AFN Bullbar | Bumper(1)** and the **Vehicle**.

The side shims(57) and (58) allows the corners of the **AFN Bullbar | Bumper(1)** to open or to close, depending if they are fitted or not.

The front shims(52) and (53) shortens or extends the distance of the **AFN Bullbar | Bumper(1)** to the **Vehicle's fenders**.

Mind that this is a precision task, please take time to correctly assemble this step.

Use them only if you have to, they are optional and may not be needed.

Once the **AFN Bullbar | Bumper(1)** is in place, there is a tightening order to it.

Tightening order:

- 1** - Start by the **4x Bolts** on the chassis;
- 2** - Then, the **4x Bolts** on top of the Winch bracket;
- 3** - The **3x Bolts** on each side, of the Winch bracket;
- 4** - The **5x Bolts** on each side, of the Recovery Points;

Check the Initial notes on adjusting the Bumper, on page 7.

Once everything is correctly fitted,
Give the final torque.

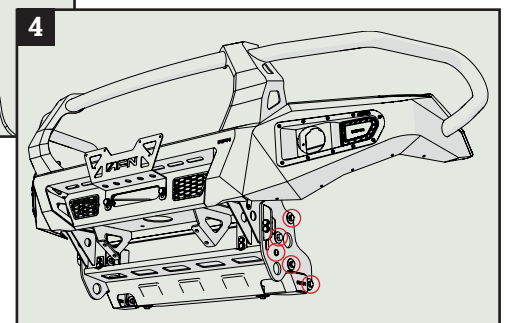
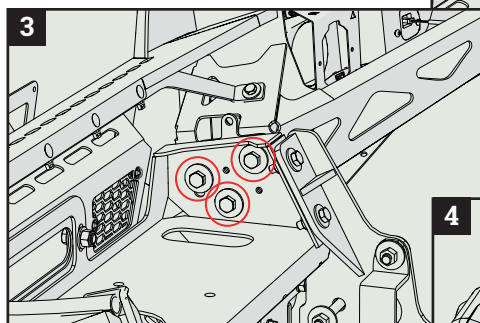
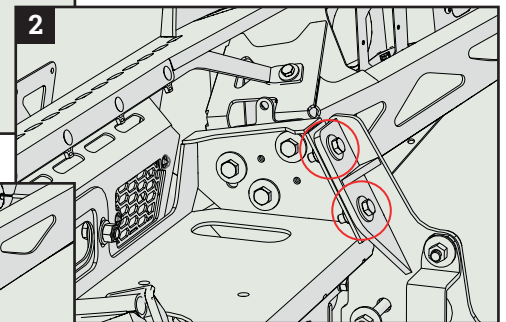
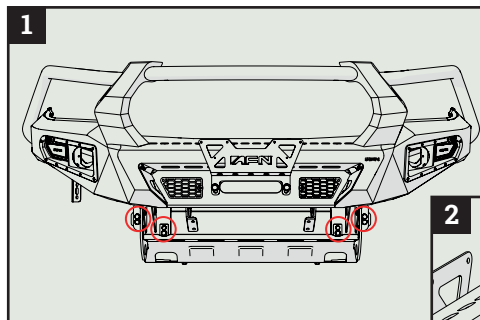
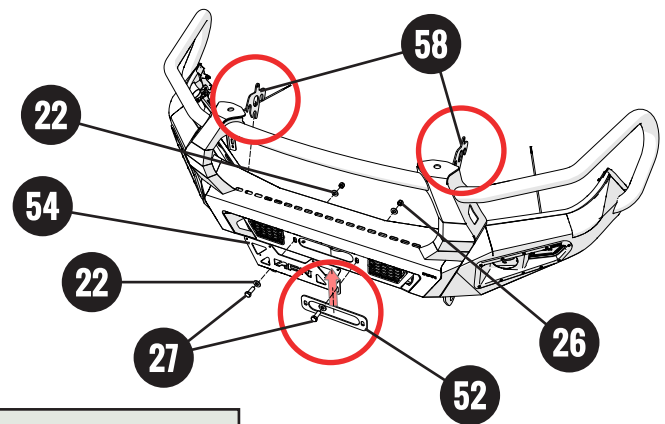

The **AFN Bullbar | Bumper(1)** must have an equal gap (10-15 mm) on both sides.

Step 7 - Fitting the Wings in the AFN Bullbar | Bumper

Preview

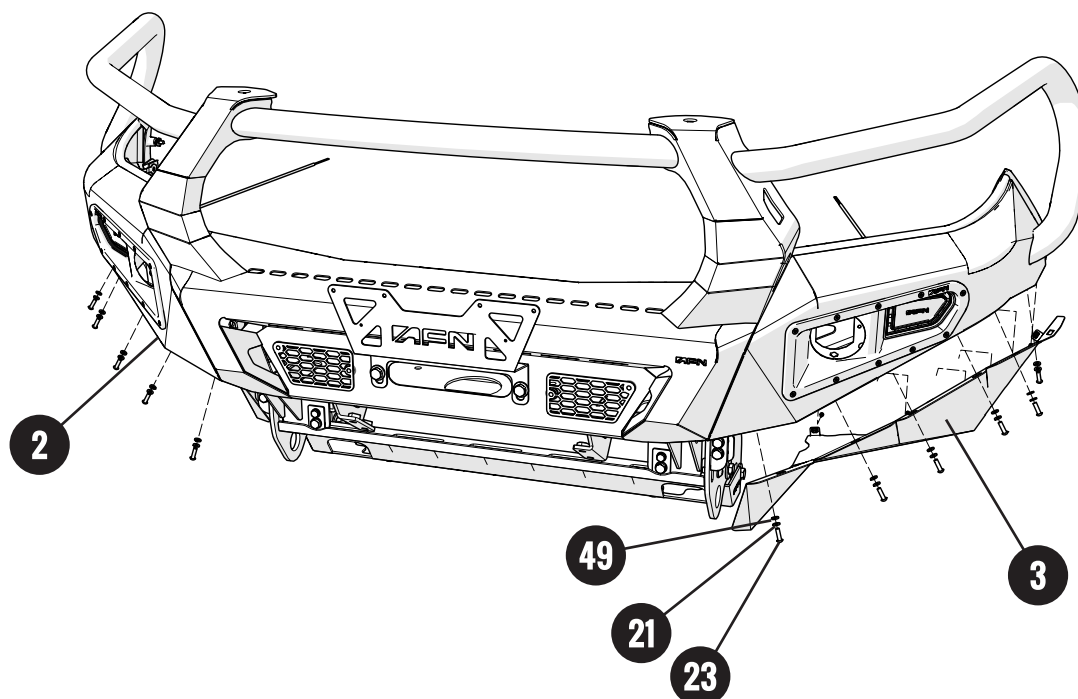

Parts needed:

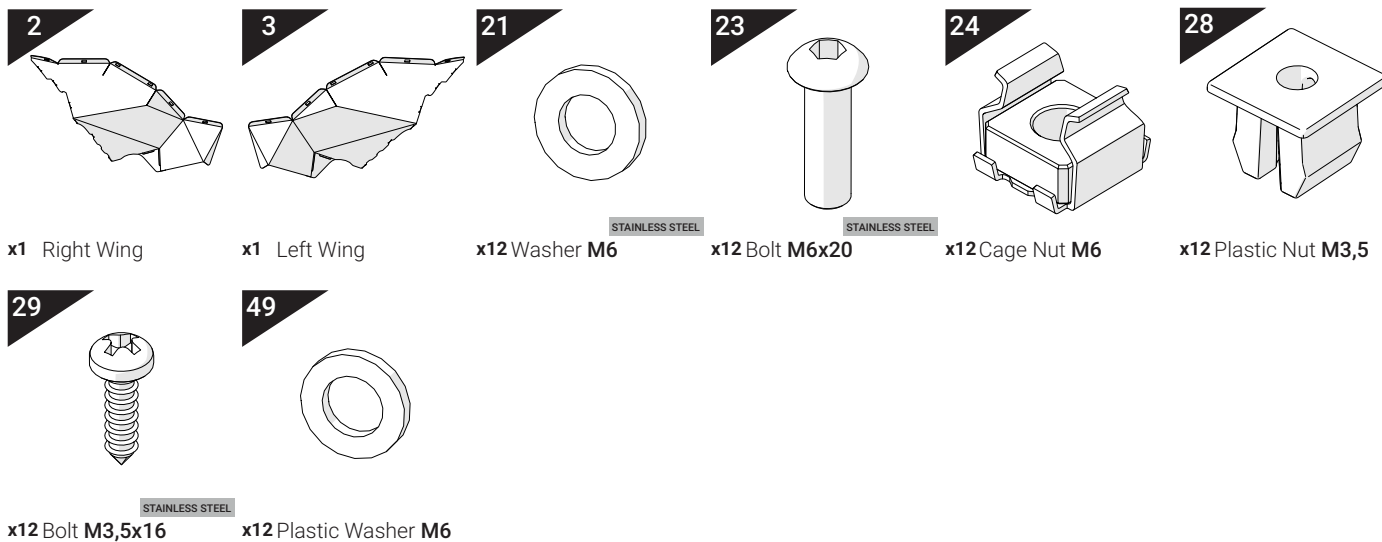

Installation

*OEM - Original Equipment Manufacturer

Step 8 - Fitting the Skid Plate in the AFN Bullbar | Bumper

Preview

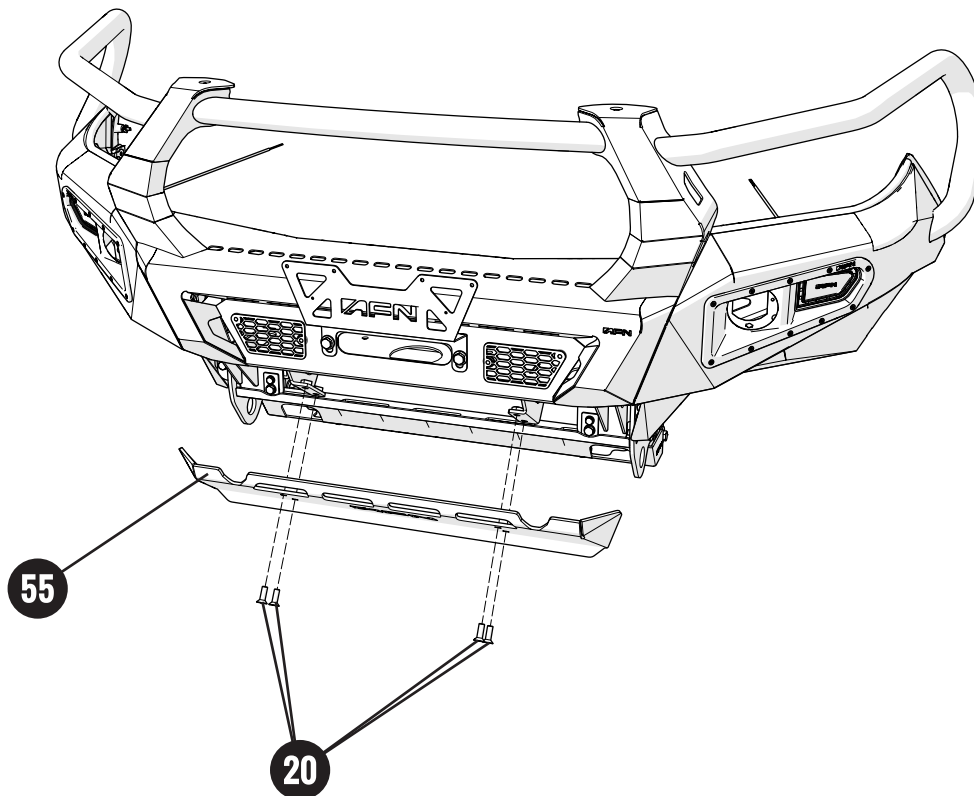

Parts needed:

20

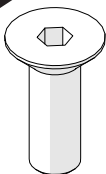

55

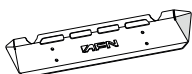

x4 Bolt M10x30 STAINLESS STEEL **x1** Front Skid Plate

Step 8 - Fitting the Skid Plate in the AFN Bullbar | Bumper**Installation**

Start by fitting the **Front Skid Plate(55)** beneath the **AFN Bullbar | Front Bumper(1)**.

Use 4x Bolts **M10x30(23)**.

Give the final torque.

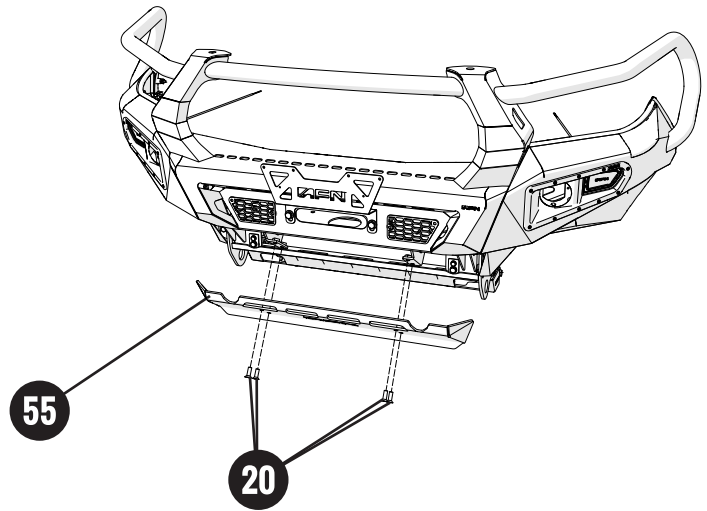

Once that is done, it's time to fully tight the 2x bolts on the **Lower Skid Plate(4)**.

Give the final torque.

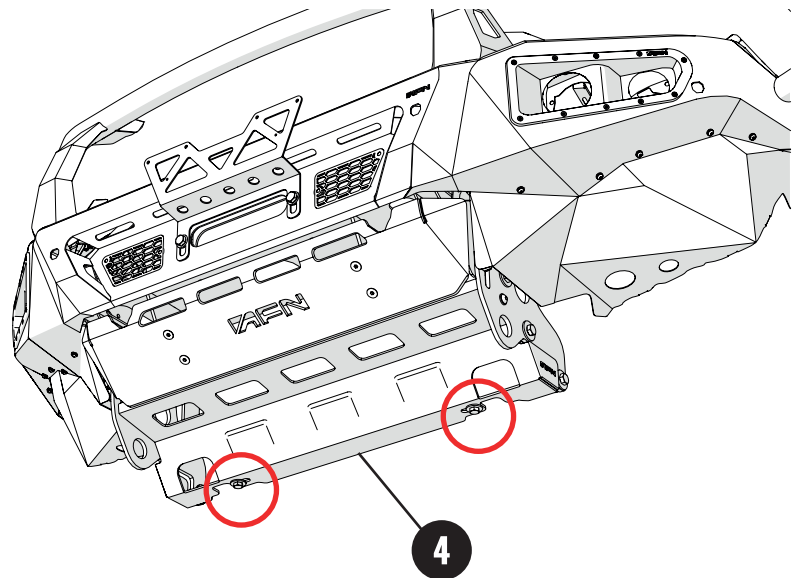

Step 9 - Final Result

Your new **AFN Bullbar | Front Bumper** is now installed on your **Mazda BT-50**!

Have Fun!



Reminder !

Before operating a vehicle fitted with an **AFN Front Bumper | Bullbar**:

- Make sure all fittings are tightened
- Check winch operation (if installed)
- Check all electrical wiring attached to lights and parking sensors (if installed)

Maintenance | Care

Periodically check and tighten all nuts. Stripped, fractured or bent bolts or nuts need to be replaced.

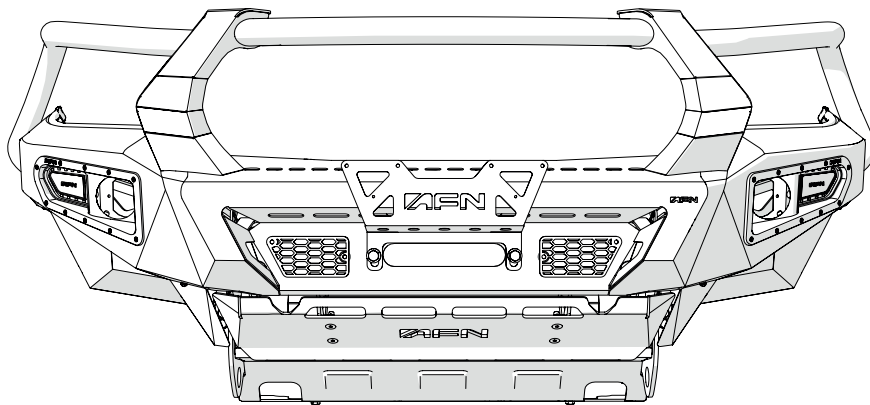



3 BT-50 CATALOGUE

AFN 4x4 Accessories is becoming a well known brand for its products due to its quality, design and safety which are challenged for thousands of people everyday, worldwide.

In its diversity of products we can include, with all-terrain quality, protection, safety and aesthetic accessories. With that being said, **AFN 4x4** has some other accessories that every offroad passionate would like to have, such as **Body Protections, Underbody Protections, Light Holders, Storage** (Wheel Supports and Jerry-can carriers) and others related to the **Aesthetics**.

We have some 4x4 accessories that combine with the original model lines that if you take a closer look you will see that they don't appear to be an accessory, but a must-have.

Please be in mind that some accessories are available only to some models.

Feel free to check all the products that may interest you in our website at: www.afn.pt



Ref.: 48002831 - Bull Bar w/ Fog Lights

4 WARRANTY TERMS

AFN4x4 products are warranted free from defects in materials and workmanship for a period of two (2) years from the date of initial retail purchase. Third-party components are delivered under the original manufacturer warranty.

Under the present warranty, **AFN4x4** obligation shall be limited to repairing, replacing or crediting, at its option, any part found to be defective.

AFN4x4 does not warrant or make any representations concerning its goods when:

- a) The products are purchased used, scratch and dent or when the box was opened.
- b) The products are not installed, used, and maintained strictly in accordance with **AFN4x4**'s instructions.
- c) The products are installed in vehicles that are used in competition.
- d) The products are installed in vehicles fitted with aftermarket non-standard tires with diameters in excess of OEM* specifications.
- e) The products are installed in vehicles with engines that have been modified to increase performance.

AFN4x4 will not be responsible for goods damaged in transit. If any goods arrive damaged, please contact the **AFN4x4** as soon as possible. **AFN4x4** will assess and may arrange to have the damaged goods returned to a **AFN4x4** Distributor and arrange for a replacement of the goods. Damaged goods must be returned in the condition received by you with all original packaging, accessories and/or manuals. If they are not returned in same condition sent there may be an additional fee charged.

To file a claim under this warranty please contact **AFN4x4** at +351 256 808 300 or via email at geral@afn.pt to request a *Returned Goods Authorization (RGA)* number and instructions for returning the defective component.

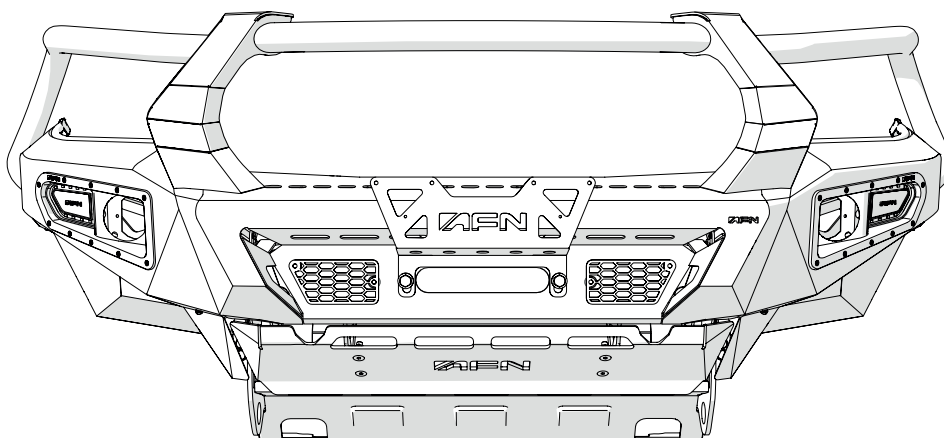

AFN LED LIGHTS 48002698_48002718_48002724

5 ATTACHMENTS

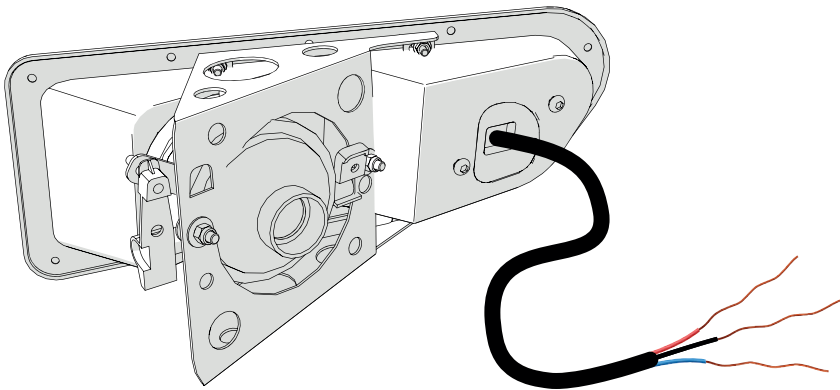

Electrical Fittings:

- The **Red One** / **Brown One** must be connected to the Positive of the OEM Day Running Light.
- The **Black One** must be connected to the Neutral cable of the vehicle.
- The **Blue One** must be connected to the Positive of the OEM blinkers.

Test if everything is correctly functioning.

DON'T JUST SETTLE FOR THE SAME OLD BULL

WELCOME TO THE AFN FAMILY

AFN[®]
4 X 4 ACCESSORIES

WWW.AFN.PT | SALES@AFN.PT | FACEBOOK.COM/AFN4X4

 **AFN**[®]
4 X 4 AUSTRALIA

Runva